



CHRISTMAS GIFT POP UP

Additional instructions to make a Medium Stacking Pop Up
using store-bought towels and a little creativity



What You Need:

Set of 2 kitchen towels (medium weight)

FQG122 Stacking Pop Up Pattern

FQG123 Medium Pop Up Refill

Inner Fabric and Ties- 1/3 yard cotton

Stabilizer - 7/8 yard (20" wide)

Ribbon - 1 yard any width



**This is only the additional steps needed to add the flaps and binding.
All other instructions are in the FQG122 Stacking Pop Up Pattern.**

Important Tidbits:

- For this example I used a set of 2 towels from a big box store approximately 16" W x 28" H. You could also purchase 1/3 yard cotton for the Outer Fabric and 1/3 yard cotton for the flaps.
- Since there was a cute border at the top and bottom, I decided to use this as the binding instead of rolling the top edge. You could use a scrap 2-1/4" x 26-1/2" instead.
- It is important to measure the image on the towel to make sure it will fit nicely on the pop up. For a Medium Pop Up the image should be no taller than 8-1/2"... no wider than 12-1/2".
- Stabilizing the Outer Side (made from the tree towel) is optional... most towels have enough body to them. Don't try using a thick/plush/velour towel... the thickness can make it difficult to deal with once things are being layered. A nice cotton kitchen towel works best.
- The Outer Base circle is cut from the plaid towel, it could also be cut from a scrap 9" x 9".
- Cut Inner Side, Base, and Ties from 1/3 yard of cotton according to FQG122 Stacking Pop Up Pattern's instructions for a Medium Pop Up.

Step 1: Cutting Towels

Press towels.

From Tree Towel cut:

Outer Side

9-1/2" H x 13-1/2" W (2)

Center trees left to right.

Bottom of image should be at least 1/2" above bottom edge.

Top of image should be at least 1/2" below top edge.

Binding Strips

2-1/4" x 13-1/2" (2)

(or 2-1/4" x 26-1/2" (1) from cotton)

From Plaid Towel cut:

Outer Base Circle (from center of towel)

8-1/2" D (1)

Flaps

8-9" x width of towel (2)

(try to use the 3 finished sides from the ends if possible. See diagram at right.)

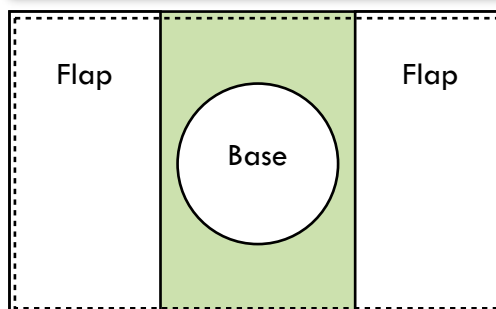

Step 2: Make Pop Up using Stacking Pattern... stop after you cut the tape from the spring.

Do Not Remove Safety Pins!

Follow instructions to make the Medium Stacking Pop Up using pattern FQG122 Stacking Pop Up Pattern and FQG123 Medium Pop Up Refill. Stop after cutting the tape from the spring. Do not remove safety pins.

Changes:

Sew the two towel pieces with the tree image together to form the Outer Side (9-1/2" x 26-1/2"). DO NOT roll the top edge to finish. You will be adding the flaps and binding instead in the following Steps.

Step 3: Add Flaps

Pin top edges of Inner (cotton) and Outer (tree towel) raw edges together, lining up marks. Baste raw edges together. Stitch raw ends of ties next to each other on top edge of the Outer Side. Backstitch over ends a few times to give them strength.

1. Mark center of raw edge of each Flap (other 3 sides should be finished from the towel).

2&3. Pin raw edges of Flaps to top edges (pop up edges you just basted in step 2). Match center marks on plaid to marks centered over the trees on side. The Flaps will overlap. **Important! The Right Side of the Flap should be against the Inner Side fabric so when pulled out and tied the finished side is showing.** Baste flap to top raw edges.

Step 4: Add Binding

4. Sew binding strips end-to-end. Mark center of raw edges of both binding pieces. If using a 26-1/2" strip of cotton, mark 4 evenly spaced points around the raw edge.

5. Press seams open. Fold in half along length and press.

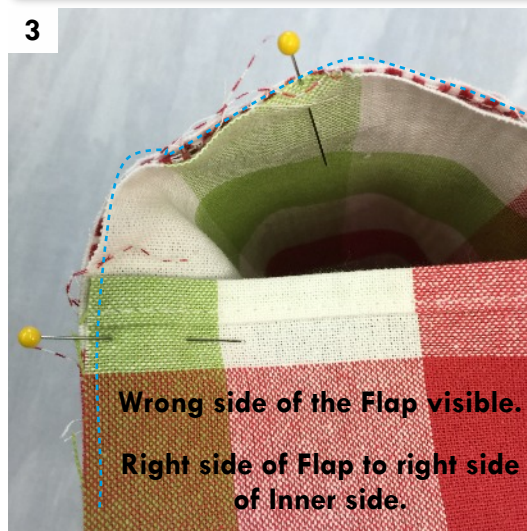

Step 4: Sew Binding to Top Edge

6. Pin Binding raw edges to inside raw Top Edge, matching marks. Stitch binding to top edge.
7. Press seam up and roll binding to Outer Side, Pin.
8. Topstitch. Pay careful attention to the flaps... they need to be pulled out of the way as you topstitch the binding. It is easy to catch them in the stitching.

Step 5: Remove Safety Pins to Finish

9. Remove safety pins to release spring.
10. Pull flaps to outside, fill with a lovely gift, and tie with ribbon.

Enjoy!
Jo

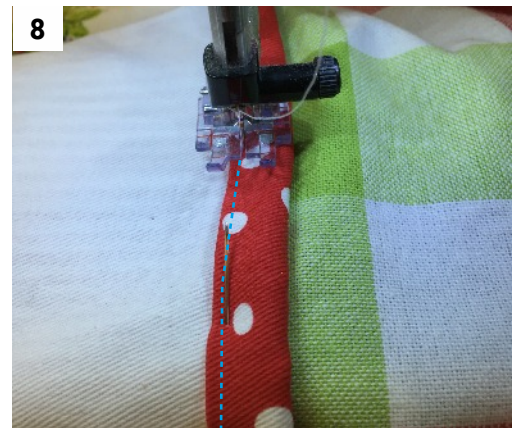

the
FAT QUARTER GYPSY

